

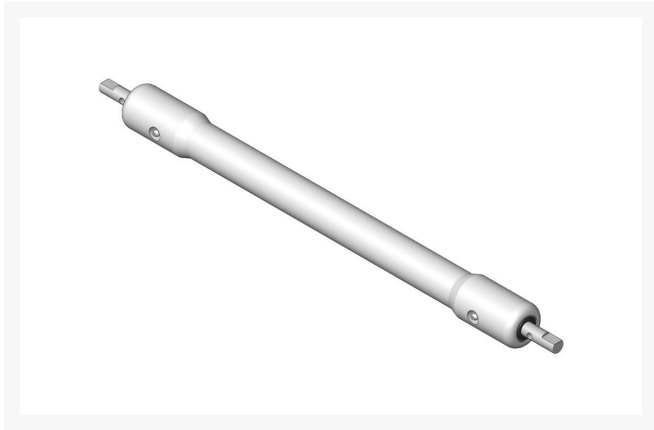

Roller - Swaged Machined Aluminum

R101122



Details

Constructed with "water-pump" style bearings, this steel tubular roller contacts the ground only on the outer 2-7/8" of the roller.

Specifications

| | |
|--------------|--------------|
| Manufacturer | R&R Products |
| Roller Body | 2 in |
| Diameter | |
| Weight (lbs) | 4 lb |

Fits Models

- Jacobsen Eclipse 122F
- Jacobsen E-Plex
- Jacobsen E-Plex II
- Jacobsen Greens King II
- Jacobsen Greens King IV
- Jacobsen Greens King V & VI
- Jacobsen G-Plex III
- Jacobsen PGM 19
- Jacobsen PGM 22

Replacement Parts

| | |
|----------|------------------|
| R21-8430 | Bearing - Roller |
| R302-5 | Fitting - Grease |

Golfmech Ltd

Hullaghfin Balrath Navan, C15 VOFS
353 87 632 9827

<https://golfmech.rrproducts.com/>